

R/W DETAILS  
N.T.S.

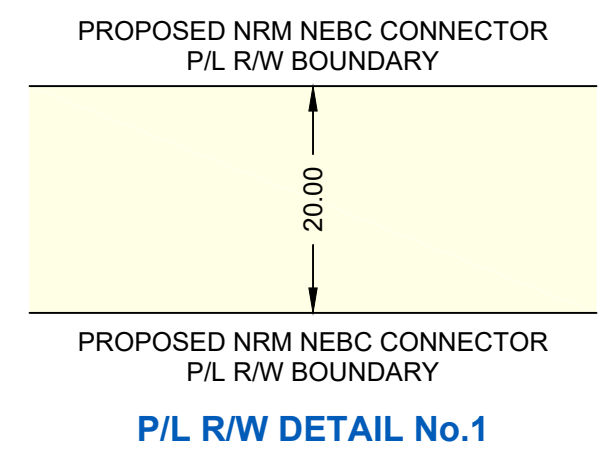

OWNERSHIP TRACT No.	NRCP-A-0381	NRCP-A-0382	ROAD	NRCP-A-0383	ROAD	NRCP-A-0384	NRCP-A-0385
AREA (ha) AND LENGTH (m) OF PERMANENT EASEMENT	AREA 0.161 LENGTH 80.5	AREA 1.923 LENGTH 961.4	LENGTH 26.1	AREA 0.536 LENGTH 268.0	LENGTH 22.3	AREA 1.627 LENGTH 813.5	AREA 1.720 LENGTH 860.0



PIPELINE PLAN AND PROFILE IN:  
S.W. 1/4 Sec.26  
S.E. 1/4 Sec.26  
N.W. 1/4 Sec.24  
N.E. 1/4 Sec.24  
Twp.79 Rge.12 W.6M.

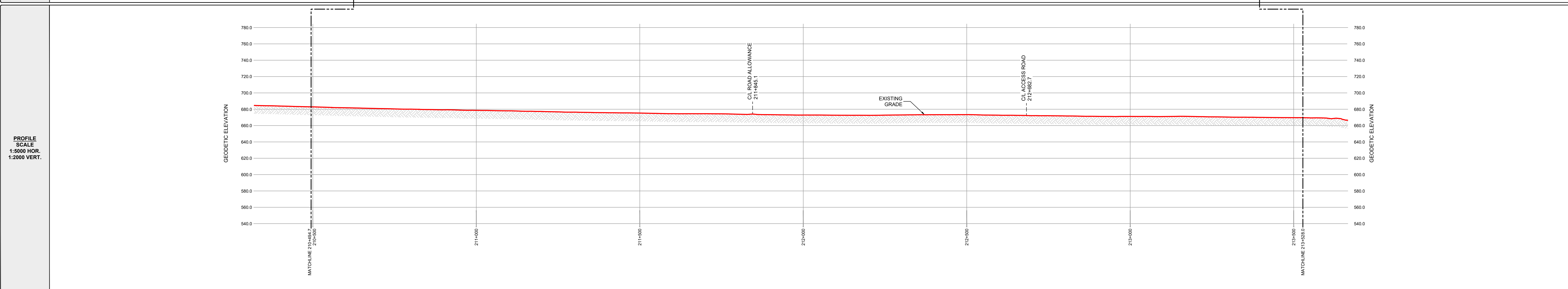

**GENERAL NOTES:**

- ALL CHAINAGES AND DIMENSIONS ARE IN METRES UNLESS NOTED OTHERWISE.
- PROFILE INFORMATION HAS BEEN OBTAINED FROM LIDAR AND FIELD SURVEY.
- CHAINAGES SHOWN ARE CONTOUR.
- THIS DOCUMENT IS NOT A PLAN OF SURVEY, BUT IS A GRAPHICAL REPRESENTATION OF THE APPROXIMATE SIZE, CONFIGURATION AND LOCATION OF PROPERTY OWNERSHIP. IT IS NOT INTENDED TO BE USED FOR LEGAL DESCRIPTIONS, CALCULATING EXACT DIMENSIONS OR PROPERTY AREAS.
- CONVERSION FACTOR FOR HECTARES TO ACRES IS: 1 HECTARE = 2.4710 ACRES.
- TYPICALLY THE RIGHT OF WAY WIDTH IS 20.0m BUT WILL VARY AT SPECIFIC LOCATIONS DUE TO ENGINEERING AND CONSTRUCTION RESTRICTIONS.
- FULL SIZE DRAWINGS ARE PLOTTED ON 707 x 1000 (B1 SIZED PAPER). REDUCED SIZE DRAWINGS ARE NOT TO SCALE.

**LEGEND:**

KILOMETRE POST:

PROPOSED PIPELINE RIGHT OF WAY:

PROPOSED VALVE SITE:

PROPERTY LINE:

A/R: ACCESS ROAD  
ha.: HECTARES  
m: METRES  
NPS: NOMINAL PIPE SIZE  
P/L: PIPELINE  
R/W: RIGHT OF WAY  
C/L: CENTRE LINE

**CER APPROVAL:**

**LAND TITLES OFFICE:**

PLAN No. \_\_\_\_\_  
ENTERED AND REGISTERED  
ON \_\_\_\_\_  
INSTRUMENT No: \_\_\_\_\_  
A.D. REGISTRAR

**REVISIONS:**

No.	DESCRIPTION	DATE	DRFT	CHK	APRV
00	PLAN ISSUED	NOV. 18, 2024	JA	WM	JH

**PLAN SHOWING:**  
Plan and Profile of NEBC Connector  
from  
KP 210+494.7 to 213+528.0  
Limits of Sheet  
S.W. 1/4 Sec.26 Twp.79 Rge.12 W.6M.  
N.E. 1/4 Sec.24 Twp.79 Rge.12 W.6M.  
Saddle Hills County - Alberta

MIDWEST SURVEYS LAND SURVEYING LTD. 10915 ALASKA ROAD FORT ST. JOHN, BC, V1J 6P3 TEL: 250-795-3992	Project Name: NEBC Connector Project No.: C-00384 Route Reference: PB000222-MSI-GS-SPD-002_18 Document No.: PA000922-MSI-DD-MAP-024_00	Sheet No.: 62.0 00 REVISION
--	---	-----------------------------------