

R/W DETAILS
N.T.S.

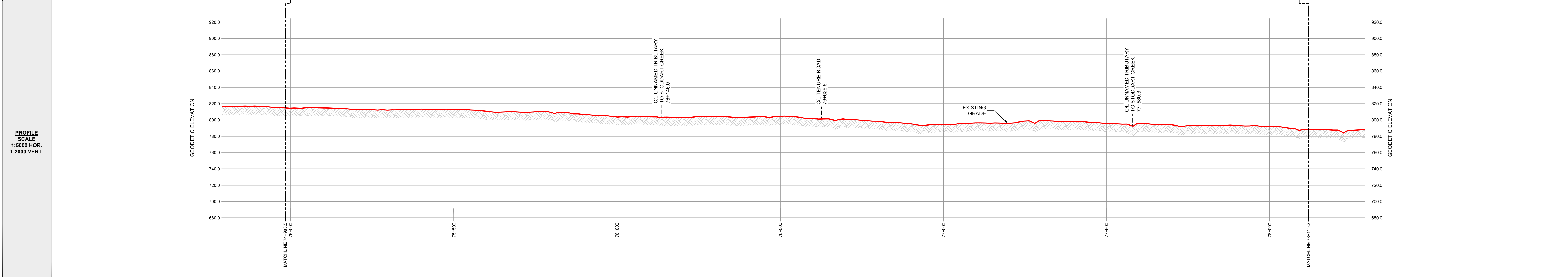

OWNERSHIP TRACT No.	NRCP-0187	NRCP-0188	NRCP-0189	NRCP-0190
AREA (ha) AND LENGTH (m) OF PERMANENT EASEMENT	AREA 0.089 LENGTH 44.7	AREA 4.003 LENGTH 2001.5	AREA 2.038 LENGTH 1018.8	AREA 0.148 LENGTH 73.9



GENERAL NOTES:

- ALL CHAINAGES AND DIMENSIONS ARE IN METRES UNLESS NOTED OTHERWISE.
- PROFILE INFORMATION HAS BEEN OBTAINED FROM LIDAR AND FIELD SURVEY.
- CHAINAGES SHOWN ARE CONTOUR.
- THIS DOCUMENT IS NOT A PLAN OF SURVEY, BUT IS A GRAPHICAL REPRESENTATION OF THE APPROXIMATE SIZE, CONFIGURATION AND LOCATION OF PROPERTY OWNERSHIP. IT IS NOT INTENDED TO BE USED FOR LEGAL DESCRIPTIONS, CALCULATING EXACT DIMENSIONS OR PROPERTY AREAS.
- CONVERSION FACTOR FOR HECTARES TO ACRES IS: 1 HECTARE = 2.4710 ACRES.
- TYPICALLY THE RIGHT OF WAY WIDTH IS 20.0m BUT WILL VARY AT SPECIFIC LOCATIONS DUE TO ENGINEERING AND CONSTRUCTION RESTRICTIONS.
- FULL SIZE DRAWINGS ARE PLOTTED ON 707 x 1000 (B1 SIZED PAPER). REDUCED SIZE DRAWINGS ARE NOT TO SCALE.

LEGEND:

KILOMETRE POST:

PROPOSED PIPELINE RIGHT OF WAY:

PROPOSED VALVE SITE:

PROPERTY LINE:

A/R: ACCESS ROAD
ha.: HECTARES
m: METRES
NPS: NOMINAL PIPE SIZE
P/L: PIPELINE
R/W: RIGHT OF WAY
C/L: CENTRE LINE

CER APPROVAL:

LAND TITLES OFFICE:

PLAN No. _____

ENTERED AND REGISTERED

ON _____

INSTRUMENT No: _____

A.D.REGISTRAR

REVISIONS:

NO.	DESCRIPTION	DATE	DRFT	CHK	APRV
00	PLAN ISSUED	NOV. 18, 2024	JA	TM	JH

PLAN SHOWING:

Plan and Profile of NEBC Connector
from
KP 74+938.5 to 78+119.2
Limits of Sheet
SW 1/4 Sec 12 Tp 87 R 21 W6M
SE 1/4 Sec 35 Tp 86 R 21 W6M
Peace River District - British Columbia

MIDWEST SURVEYS LAND SURVEYING LTD. 10515 ALASKA ROAD FORT ST. JOHN, BC, V1J 6P3 TEL: 250-795-3992	Project Name: NEBC Connector Project No.: C-00384 Route Reference: PB000222-MSI-GS-SPD-002_18 Document No.: PB000222-MSI-DD-MAP-224_00	Sheet No.: 23.0 00 REVISION
---	---	--