

R/W DETAILS
N.T.S.

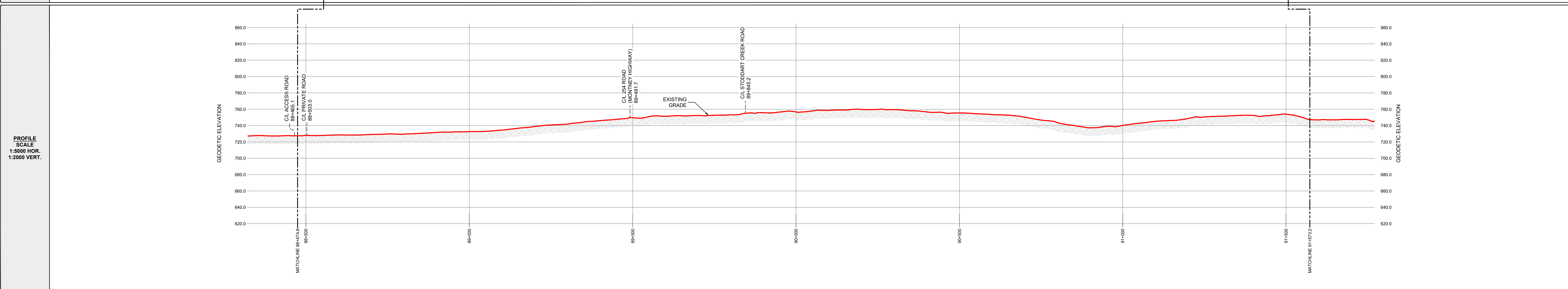

| | | | | | | | | |
|--|---------------------------|----------------------------|-------------|----------------------------|-------------|----------------------------|----------------------------|---------------------------|
| OWNERSHIP TRACT No. | NRCP-0206 | NRCP-0207 | ROAD | NRCP-0208 | ROAD | NRCP-0209 | NRCP-0210 | NRCP-0211.1 |
| AREA (ha) AND LENGTH (m) OF PERMANENT EASEMENT | AREA 0.054 LENGTH 27.2 | AREA 1.926 LENGTH 963.0 | LENGTH 47.7 | AREA 0.634 LENGTH 317.2 | LENGTH 27.9 | AREA 1.580 LENGTH 789.8 | AREA 1.807 LENGTH 903.5 | AREA 0.035 LENGTH 17.3 |



GENERAL NOTES:

- ALL CHAINAGES AND DIMENSIONS ARE IN METRES UNLESS NOTED OTHERWISE.
- PROFILE INFORMATION HAS BEEN OBTAINED FROM LIDAR AND FIELD SURVEY.
- CHAINAGES SHOWN ARE CONTOUR.
- THIS DOCUMENT IS NOT A PLAN OF SURVEY, BUT IS A GRAPHICAL REPRESENTATION OF THE APPROXIMATE SIZE, CONFIGURATION AND LOCATION OF PROPERTY OWNERSHIP. IT IS NOT INTENDED TO BE USED FOR LEGAL DESCRIPTIONS, CALCULATING EXACT DIMENSIONS OR PROPERTY AREAS.
- CONVERSION FACTOR FOR HECTARES TO ACRES IS: 1 HECTARE = 2.4710 ACRES.
- TYPICALLY THE RIGHT OF WAY WIDTH IS 20.0m BUT WILL VARY AT SPECIFIC LOCATIONS DUE TO ENGINEERING AND CONSTRUCTION RESTRICTIONS.
- FULL SIZE DRAWINGS ARE PLOTTED ON 707 x 1000 (B1 SIZED PAPER). REDUCED SIZE DRAWINGS ARE NOT TO SCALE.

LEGEND:

KILOMETRE POST:

PROPOSED PIPELINE RIGHT OF WAY:

PROPOSED VALVE SITE:

PROPERTY LINE:

A/R: ACCESS ROAD
ha.: HECTARES
m: METRES
NPS: NOMINAL PIPE SIZE
P/L: PIPELINE
R/W: RIGHT OF WAY
C/L: CENTRE LINE

CER APPROVAL:

LAND TITLES OFFICE:

PLAN No. _____
ENTERED AND REGISTERED
ON _____
INSTRUMENT No: _____
A.D.REGISTRAR

REVISIONS:

| NO. | DESCRIPTION | DATE | DRFT | CHK | APRV |
|-----|-------------|---------------|------|-----|------|
| 00 | PLAN ISSUED | NOV. 18, 2024 | JA | TM | JH |

PLAN SHOWING:
Plan and Profile of NEBC Connector
from
KP 88+474.6 to 91+573.2
Limits of Sheet
NE 1/4 Sec 4 Tp 86 R 20 W6M
SE 1/4 Sec 34 Tp 85 R 20 W6M
Peace River District - British Columbia

MIDWEST SURVEYS
LAND SURVEYING LTD.
10915 ALASKA ROAD
FORT ST. JOHN, BC, V1J 6P3
TEL: 250-795-3902

Project Name: NEBC Connector
Project No.: C-00364
Route Reference: PB00222-MSI-GS-SPD-002_18
Document No.: PB00222-MSI-DD-MAP-228_00

Sheet No.: 27.0
REVISION
00