

R/W DETAILS
N.T.S.

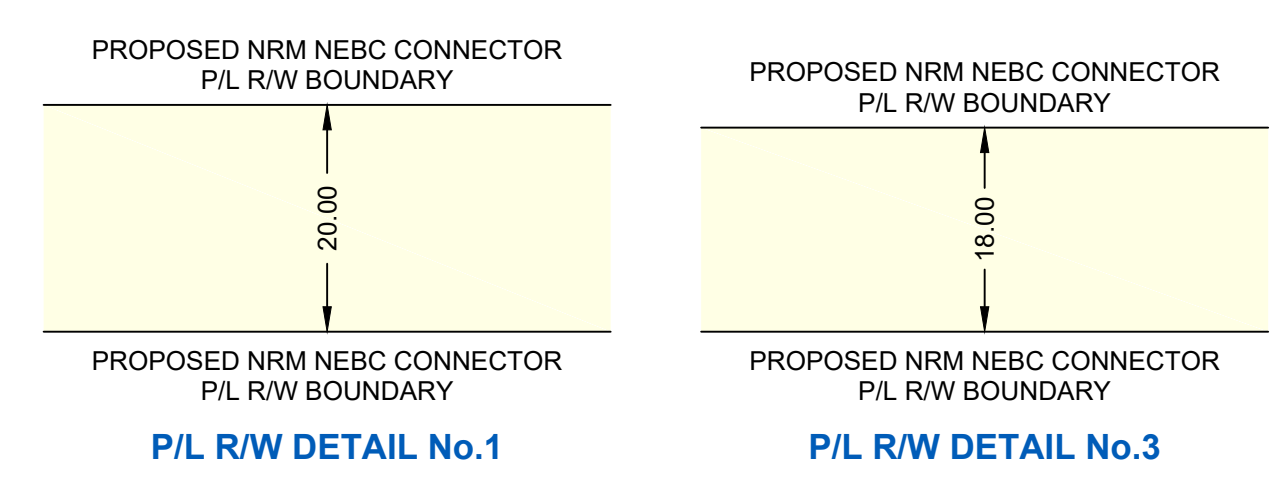

OWNERSHIP TRACT No.	NRCP-0226.1	NRCP-0227.1	NRCP-0225	NRCP-0226	NRCP-0227	NRCP-0227.2	NRCP-0227	ROAD	NRCP-0228.1	ROAD
AREA (ha) AND LENGTH (m) OF PERMANENT EASEMENT	AREA 1.610 LENGTH 804.9	AREA 0.178 LENGTH 89.1	AREA 1.444 LENGTH 721.8	AREA 0.356 LENGTH 179.3	AREA 0.382 LENGTH 209.1	AREA 0.003 LENGTH 1.1	AREA 1.409 LENGTH 766.5	LENGTH 40.2	AREA 0.313 LENGTH 156.5	LENGTH 20.1

FOR CONTINUATION SEE DRAWING: PB000222-MSI-DD-MAP-231

PLAN SCALE 1:5000



PIPELINE PLAN AND PROFILE IN:
SE 1/4 Sec 9
NE 1/4 Sec 4
NW 1/4 Sec 4
Lot 2 Plan PGP38967
Lot 1 Plan PGP38967
Lot A St. John Indian Reserve No 172
District Plan EPP9991
Tp 85 R 19 W6M

PROFILE SCALE
1:5000 HOR.
1:2000 VERT.

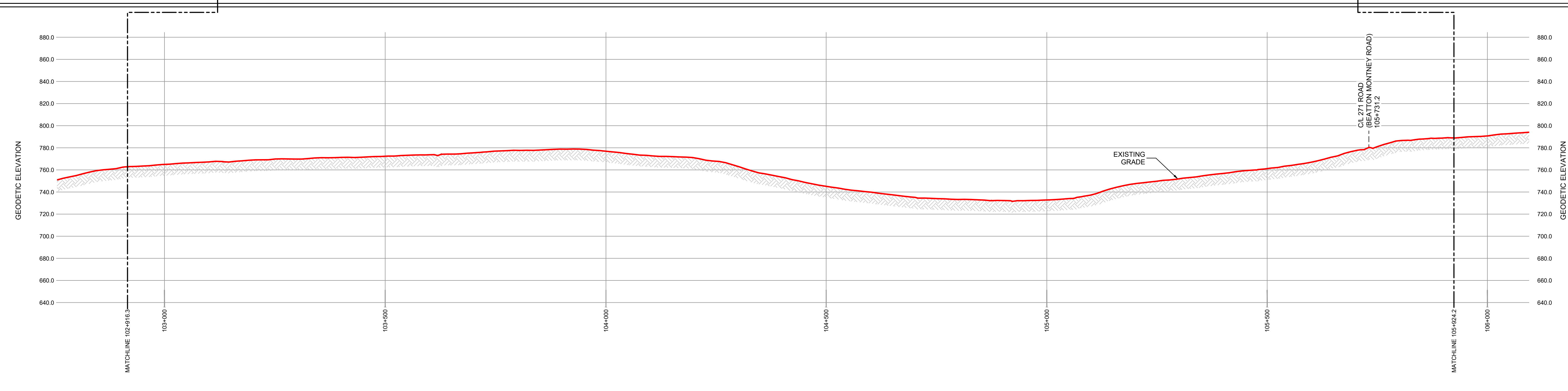

GENERAL NOTES:

- ALL CHAINAGES AND DIMENSIONS ARE IN METRES UNLESS NOTED OTHERWISE.
- PROFILE INFORMATION HAS BEEN OBTAINED FROM LIDAR AND FIELD SURVEY.
- CHAINAGES SHOWN ARE CONTOUR.
- THIS DOCUMENT IS NOT A PLAN OF SURVEY, BUT IS A GRAPHICAL REPRESENTATION OF THE APPROXIMATE SIZE, CONFIGURATION AND LOCATION OF PROPERTY OWNERSHIP. IT IS NOT INTENDED TO BE USED FOR LEGAL DESCRIPTIONS, CALCULATING EXACT DIMENSIONS OR PROPERTY AREAS.
- CONVERSION FACTOR FOR HECTARES TO ACRES IS: 1 HECTARE = 2.4710 ACRES.
- TYPICALLY THE RIGHT OF WAY WIDTH IS 20.0m BUT WILL VARY AT SPECIFIC LOCATIONS DUE TO ENGINEERING AND CONSTRUCTION RESTRICTIONS.
- FULL SIZE DRAWINGS ARE PLOTTED ON 707 x 1000 (B1 SIZED PAPER). REDUCED SIZE DRAWINGS ARE NOT TO SCALE.

LEGEND:

KILOMETRE POST:

PROPOSED PIPELINE RIGHT OF WAY:

PROPOSED VALVE SITE:

PROPERTY LINE:

A/R: ACCESS ROAD
ha.: HECTARES
m: METRES
NPS: NOMINAL PIPE SIZE
P/L: PIPELINE
R/W: RIGHT OF WAY
C/L: CENTRE LINE

CER APPROVAL:

LAND TITLES OFFICE:

PLAN No. _____
ENTERED AND REGISTERED
ON _____
INSTRUMENT No: _____
A.D.REGISTRAR

REVISIONS:

NO.	DESCRIPTION	DATE	DRFT	CHK	APRV
00	PLAN ISSUED	NOV. 18, 2024	JA	WM	JH

PLAN SHOWING:
Plan and Profile of NEBC Connector
from
KP 102+916.3 to 105+924.2
Limits of Sheet
SE 1/4 Sec 9 Tp 85 R 19 W6M
SW 1/4 Sec 3 Tp 85 R 19 W6M
Peace River District - British Columbia

MIDWEST SURVEYS LAND SURVEYING LTD. 10915 ALASKA ROAD FORT ST. JOHN, BC, V1J 6P3 TEL: 250-795-3902	Project Name: NEBC Connector Project No.: C-00364 Route Reference: PB000222-MSI-GS-SPD-002_18 Document No.: PB000222-MSI-DD-MAP-232_00	Sheet No.: 31.0 00 REVISION
--	---	-----------------------------------