

R/W DETAILS
N.T.S.

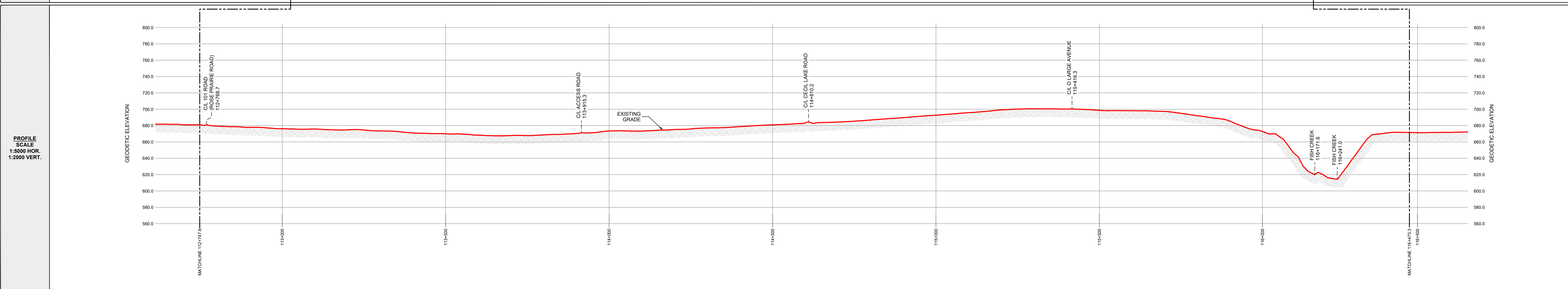

OWNERSHIP TRACT No.	ROAD	NRCP-0239.1	NRCP-0240.2	NRCP-0241.1	ROAD	NRCP-0243	ROAD	NRCP-0244	ROAD	NRCP-0245	ROAD
AREA (ha) AND LENGTH (m) OF PERMANENT EASEMENT	LENGTH	AREA 1.429 LENGTH 714.4	AREA 0.228 LENGTH 114.1	AREA 1.944 LENGTH 971.9	LENGTH	AREA 1.551 LENGTH 775.3	LENGTH	AREA 1.178 LENGTH 588.9	LENGTH	AREA 0.742 LENGTH 370.9	LENGTH



GENERAL NOTES:

- ALL CHAINAGES AND DIMENSIONS ARE IN METRES UNLESS NOTED OTHERWISE.
- PROFILE INFORMATION HAS BEEN OBTAINED FROM LIDAR AND FIELD SURVEY.
- CHAINAGES SHOWN ARE CONTOUR.
- THIS DOCUMENT IS NOT A PLAN OF SURVEY, BUT IS A GRAPHICAL REPRESENTATION OF THE APPROXIMATE SIZE, CONFIGURATION AND LOCATION OF PROPERTY OWNERSHIP. IT IS NOT INTENDED TO BE USED FOR LEGAL DESCRIPTIONS, CALCULATING EXACT DIMENSIONS OR PROPERTY AREAS.
- CONVERSION FACTOR FOR HECTARES TO ACRES IS: 1 HECTARE = 2.4710 ACRES.
- TYPICALLY THE RIGHT OF WAY WIDTH IS 20.0m BUT WILL VARY AT SPECIFIC LOCATIONS DUE TO ENGINEERING AND CONSTRUCTION RESTRICTIONS.
- FULL SIZE DRAWINGS ARE PLOTTED ON 707 x 1000 (B1 SIZED PAPER). REDUCED SIZE DRAWINGS ARE NOT TO SCALE.

LEGEND:

KILOMETRE POST:

PROPOSED PIPELINE RIGHT OF WAY:

PROPOSED VALVE SITE:

PROPERTY LINE:

A/R: ACCESS ROAD
ha.: HECTARES
m: METRES
NPS: NOMINAL PIPE SIZE
P/L: PIPELINE
R/W: RIGHT OF WAY
C/L: CENTRE LINE

CER APPROVAL:

LAND TITLES OFFICE:

PLAN No. _____
ENTERED AND REGISTERED
ON _____
INSTRUMENT No: _____
A.D.REGISTRAR

REVISIONS:

NO.	DESCRIPTION	DATE	DRFT	CHK	APRV
00	PLAN ISSUED	NOV. 18, 2024	JA	WM	JH

**NORTH RIVER
MIDSTREAM**

PLAN SHOWING:
Plan and Profile of NEBC Connector
from
KP 112+747.6 to 116+475.3
Limits of Sheet
NW 1/4 Sec 19 Tp 84 R 18 W6M
SW 1/4 Sec 17 Tp 84 R 18 W6M
Peace River District - British Columbia

MIDWEST SURVEYS LAND SURVEYING LTD. 10915 ALASKA ROAD FORT ST. JOHN, BC, V1J 6P3 TEL: 250-795-3902	Project Name: NEBC Connector Project No.: C-00364 Route Reference: PB000222-MSI-GS-SPD-002_18 Document No.: PB000222-MSI-DD-MAP-235_00	Sheet No.: 34.0 00 REVISION
--	---	--