

R/W DETAILS  
N.T.S.

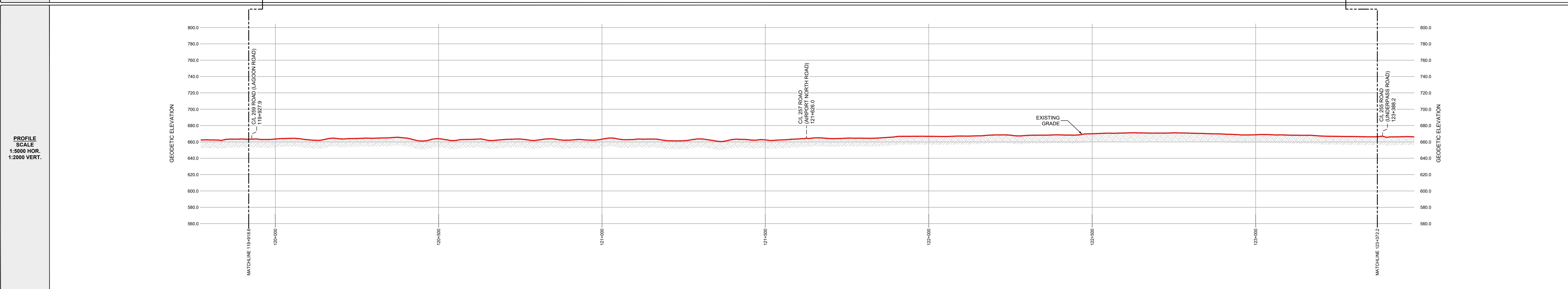

OWNERSHIP TRACT No.	ROAD	NRCP-0251	NRCP-0252	NRCP-0253	ROAD	NRCP-0254	NRCP-0255	NRCP-0256
AREA (ha) AND LENGTH (m) OF PERMANENT EASEMENT	LENGTH 25.4	AREA 0.832 LENGTH 415.8	AREA 0.831 LENGTH 415.7	AREA 1.673 LENGTH 836.4	LENGTH 25.4	AREA 1.668 LENGTH 833.9	AREA 0.182 LENGTH 91.5	AREA 1.624 LENGTH 812.2



**GENERAL NOTES:**

- ALL CHAINAGES AND DIMENSIONS ARE IN METRES UNLESS NOTED OTHERWISE.
- PROFILE INFORMATION HAS BEEN OBTAINED FROM LIDAR AND FIELD SURVEY.
- CHAINAGES SHOWN ARE CONTOUR.
- THIS DOCUMENT IS NOT A PLAN OF SURVEY, BUT IS A GRAPHICAL REPRESENTATION OF THE APPROXIMATE SIZE, CONFIGURATION AND LOCATION OF PROPERTY OWNERSHIP. IT IS NOT INTENDED TO BE USED FOR LEGAL DESCRIPTIONS, CALCULATING EXACT DIMENSIONS OR PROPERTY AREAS.
- CONVERSION FACTOR FOR HECTARES TO ACRES IS: 1 HECTARE = 2.4710 ACRES.
- TYPICALLY THE RIGHT OF WAY WIDTH IS 20.0m BUT WILL VARY AT SPECIFIC LOCATIONS DUE TO ENGINEERING AND CONSTRUCTION RESTRICTIONS.
- FULL SIZE DRAWINGS ARE PLOTTED ON 707 x 1000 (B1 SIZED PAPER). REDUCED SIZE DRAWINGS ARE NOT TO SCALE.

**LEGEND:**

KILOMETRE POST:

PROPOSED PIPELINE RIGHT OF WAY:

PROPOSED VALVE SITE:

PROPERTY LINE:

A/R: ACCESS ROAD  
ha.: HECTARES  
m: METRES  
NPS: NOMINAL PIPE SIZE  
P/L: PIPELINE  
R/W: RIGHT OF WAY  
C/L: CENTRE LINE

**CER APPROVAL:**

**LAND TITLES OFFICE:**

PLAN No. \_\_\_\_\_  
ENTERED AND REGISTERED  
ON \_\_\_\_\_  
INSTRUMENT No: \_\_\_\_\_  
A.D.REGISTRAR

**REVISIONS:**

NO.	DESCRIPTION	DATE	DRFT	CHK	APRV
00	PLAN ISSUED	NOV. 18, 2024	JA	TM	JH

**PLAN SHOWING:**

**Plan and Profile of NEBC Connector**  
from  
**KP 119+918.6 to 123+372.2**  
Limits of Sheet  
**SW 1/4 Sec 10 Tp 84 R 18 W6M**  
**NE 1/4 Sec 2 Tp 84 R 18 W6M**  
Peace River District - British Columbia

MIDWEST SURVEYS LAND SURVEYING LTD. 10915 ALASKA ROAD FORT ST. JOHN, BC, V1J 6P3 TEL: 250-795-3902	Project Name: NEBC Connector Project No.: 0-00364 Route Reference: PB000222-MSI-GS-SPD-002_18 Document No.: PB000222-MSI-DD-MAP-237_00	Sheet No.: 36.0 <b>00</b> REVISION
--	---	--