

R/W DETAILS
N.T.S.



OWNERSHIP TRACT No.								
ROAD								
AREA (ha) AND LENGTH (m) OF PERMANENT EASEMENT	LENGTH 24.4	AREA 1.016 LENGTH 506.0	AREA 0.634 LENGTH 317.1	AREA 1.833 LENGTH 916.7	AREA 0.989 LENGTH 494.1	LENGTH 34.8	AREA 0.963 LENGTH 481.4	AREA 1.918 LENGTH 959.2



PIPELINE PLAN AND PROFILE IN:
 NW 1/4 Sec 31
 NE 1/4 Sec 31
 SE 1/4 Sec 31
 NE 1/4 Sec 30
 NW 1/4 Sec 29
 SW 1/4 Sec 29
 Tp 83 R 17 W6M

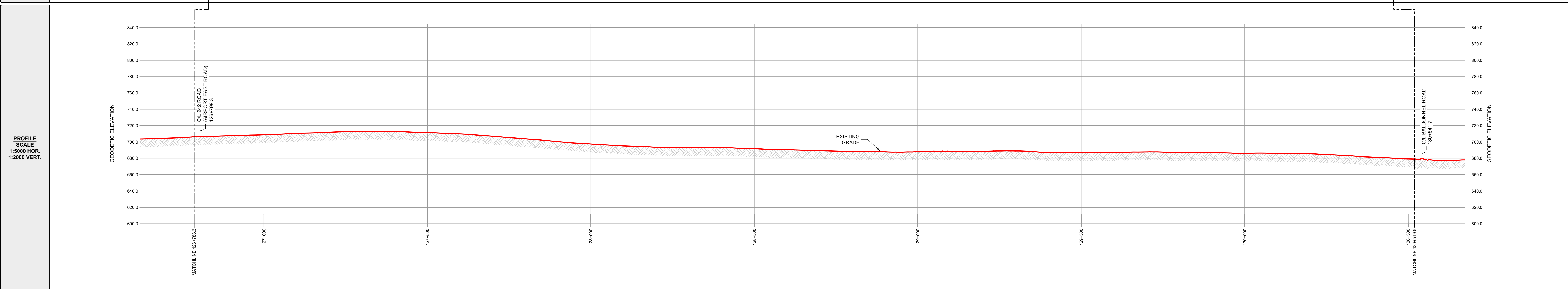

GENERAL NOTES:

- ALL CHAINAGES AND DIMENSIONS ARE IN METRES UNLESS NOTED OTHERWISE.
- PROFILE INFORMATION HAS BEEN OBTAINED FROM LIDAR AND FIELD SURVEY.
- CHAINAGES SHOWN ARE CONTOUR.
- THIS DOCUMENT IS NOT A PLAN OF SURVEY, BUT IS A GRAPHICAL REPRESENTATION OF THE APPROXIMATE SIZE, CONFIGURATION AND LOCATION OF PROPERTY OWNERSHIP. IT IS NOT INTENDED TO BE USED FOR LEGAL DESCRIPTIONS, CALCULATING EXACT DIMENSIONS OR PROPERTY AREAS.
- CONVERSION FACTOR FOR HECTARES TO ACRES IS: 1 HECTARE = 2.4710 ACRES.
- TYPICALLY THE RIGHT OF WAY WIDTH IS 20.0m BUT WILL VARY AT SPECIFIC LOCATIONS DUE TO ENGINEERING AND CONSTRUCTION RESTRICTIONS.
- FULL SIZE DRAWINGS ARE PLOTTED ON 707 x 1000 (B1 SIZED PAPER). REDUCED SIZE DRAWINGS ARE NOT TO SCALE.

LEGEND:

KILOMETRE POST:

PROPOSED PIPELINE RIGHT OF WAY:

PROPOSED VALVE SITE:

PROPERTY LINE:

A/R: ACCESS ROAD
 ha.: HECTARES
 m: METRES
 NPS: NOMINAL PIPE SIZE
 P/L: PIPELINE
 R/W: RIGHT OF WAY
 C/L: CENTRE LINE

CER APPROVAL:

LAND TITLES OFFICE:

PLAN No. _____
 ENTERED AND REGISTERED
 ON _____
 INSTRUMENT No: _____
 A.D.REGISTRAR

REVISIONS:

NO.	DESCRIPTION	DATE	DRFT	CHK	APRV
00	PLAN ISSUED	NOV. 18, 2024	JA	WM	JH

PLAN SHOWING:
Plan and Profile of NEBC Connector
 from
KP 126+786.3 to 130+519.5
 Limits of Sheet
NW 1/4 Sec 31 Tp 83 R 17 W6M
SW 1/4 Sec 29 Tp 83 R 17 W6M
 Peace River District - British Columbia

MIDWEST SURVEYS LAND SURVEYING LTD. 10915 ALASKA ROAD FORT ST. JOHN, BC, V1J 6P3 TEL: 250-795-3902	Project Name: NEBC Connector Project No.: C-00364 Route Reference: PB000222-MSI-GS-SPD-002_18 Document No.: PB000222-MSI-DD-MAP-239_00	Sheet No.: 38.0 00 REVISION
---	---	--