

R/W DETAILS  
N.T.S.

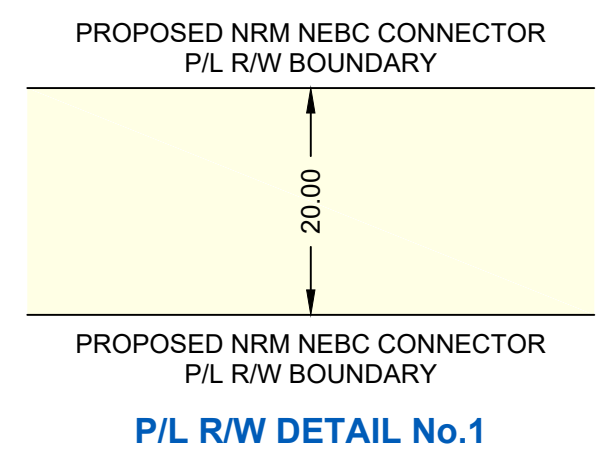

OWNERSHIP TRACT No.		NRCP-0350	ROAD	NRCP-0351	NRCP-0352	NRCP-0353	ROAD	NRCP-0354
AREA (ha) AND LENGTH (m) OF PERMANENT EASEMENT		AREA 1.663 LENGTH 831.5	LENGTH 20.9	AREA 0.725 LENGTH 362.4	AREA 0.951 LENGTH 475.3	AREA 1.666 LENGTH 833.0	LENGTH 20.8	AREA 1.115 LENGTH 557.6



PLAN SCALE 1:5000

FOR CONTINUATION SEE DRAWING: PB000222-MSI-DD-MAP-256

PIPELINE PLAN AND PROFILE IN:  
NE 1/4 Sec 12  
Tp 80 R 14 W6M  
NW 1/4 Sec 7  
SW 1/4 Sec 7  
SE 1/4 Sec 7  
SW 1/4 Sec 8  
Tp 80 R 13 W6M

FOR CONTINUATION SEE DRAWING: PA000222-MSI-DD-MAP-019

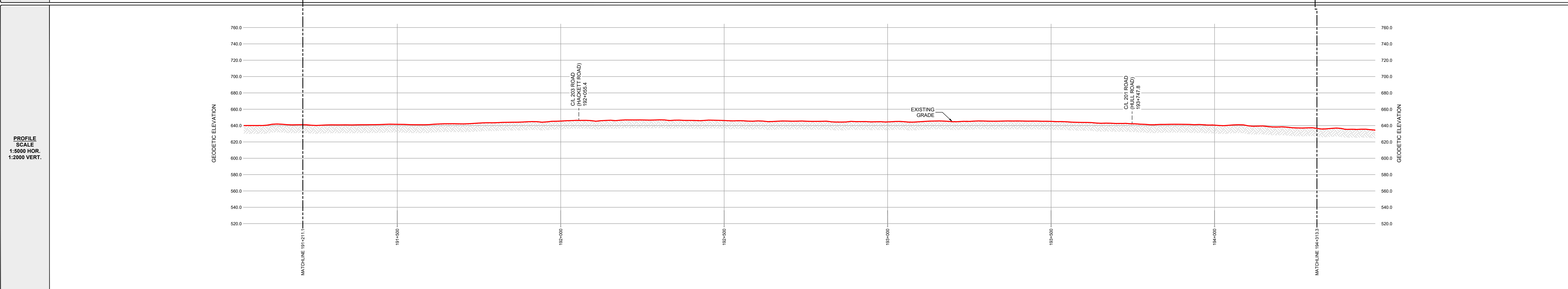

PROFILE SCALE  
1:5000 HOR.  
1:2000 VERT.

**GENERAL NOTES:**

- ALL CHAINAGES AND DIMENSIONS ARE IN METRES UNLESS NOTED OTHERWISE.
- PROFILE INFORMATION HAS BEEN OBTAINED FROM LIDAR AND FIELD SURVEY.
- CHAINAGES SHOWN ARE CONTOUR.
- THIS DOCUMENT IS NOT A PLAN OF SURVEY, BUT IS A GRAPHICAL REPRESENTATION OF THE APPROXIMATE SIZE, CONFIGURATION AND LOCATION OF PROPERTY OWNERSHIP. IT IS NOT INTENDED TO BE USED FOR LEGAL DESCRIPTIONS, CALCULATING EXACT DIMENSIONS OR PROPERTY AREAS.
- CONVERSION FACTOR FOR HECTARES TO ACRES IS: 1 HECTARE = 2.4710 ACRES.
- TYPICALLY THE RIGHT OF WAY WIDTH IS 20.0m BUT WILL VARY AT SPECIFIC LOCATIONS DUE TO ENGINEERING AND CONSTRUCTION RESTRICTIONS.
- FULL SIZE DRAWINGS ARE PLOTTED ON 707 x 1000 (B1 SIZED PAPER). REDUCED SIZE DRAWINGS ARE NOT TO SCALE.

**LEGEND:**

KILOMETRE POST:	
PROPOSED PIPELINE RIGHT OF WAY:	
PROPOSED VALVE SITE:	
PROPERTY LINE:	
A/R: ACCESS ROAD	
ha.: HECTARES	
m: METRES	
NPS: NOMINAL PIPE SIZE	
P/L: PIPELINE	
R/W: RIGHT OF WAY	
C/L: CENTRE LINE	

**CER APPROVAL:**

\_\_\_\_\_

**LAND TITLES OFFICE:**

**PLAN No.** \_\_\_\_\_

**ENTERED AND REGISTERED**

**ON** \_\_\_\_\_

**INSTRUMENT No.:** \_\_\_\_\_

**A.D.REGISTRAR**

**REVISIONS:**

NO.	DESCRIPTION	DATE	DRFT	CHK	APRV
00	PLAN ISSUED	NOV. 18, 2024	JA	WM	JH

**PLAN SHOWING:**

**Plan and Profile of NEBC Connector**  
from  
**KP 191+211.1 to 194+313.3**  
Limits of Sheet  
**NE 1/4 Sec 12 Tp 80 R 14 W6M**  
**SW 1/4 Sec 8 Tp 80 R 13 W6M**  
Peace River District - British Columbia

MIDWEST SURVEYS LAND SURVEYING LTD. 10915 ALASKA ROAD FORT ST. JOHN, BC, V1J 6P3 TEL: 250-795-3902	Project Name: NEBC Connector Project No.: C-00364 Route Reference: PB000222-MSI-GS-SPD-002_18 Document No.: PB000222-MSI-DD-MAP-257_00	Sheet No.: 56.0 <b>00</b> REVISION
--	---	--